

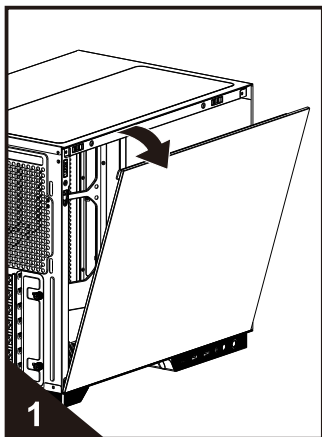

valuetop.com.bd/download

Please download and install the temperature display software

1 Disassembly of left tempered glass side panel, front tempered glass panel and right side panel.



Break up the tempered glass outward according to the arrow direction to disassemble it.

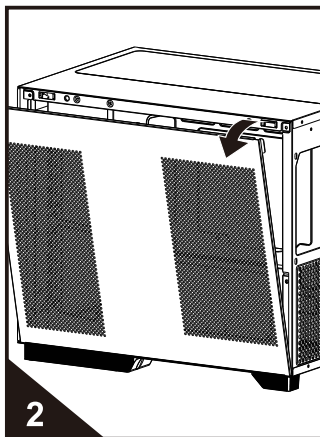

Break up the right side panel outward according to the arrow direction to disassemble it.

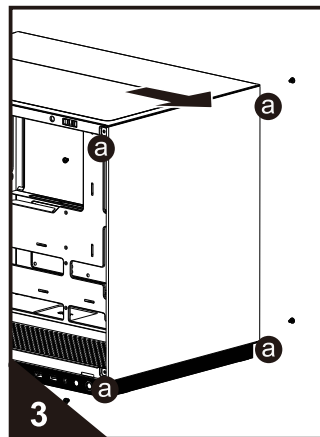

Unscrew the screws of "a" positions, then take out the front tempered glass according to arrow direction.

2 PSU installation (support ATX PSU)

Install PSU in the position as shown in the illustration, then fix it by 4 screws at "a" positions.

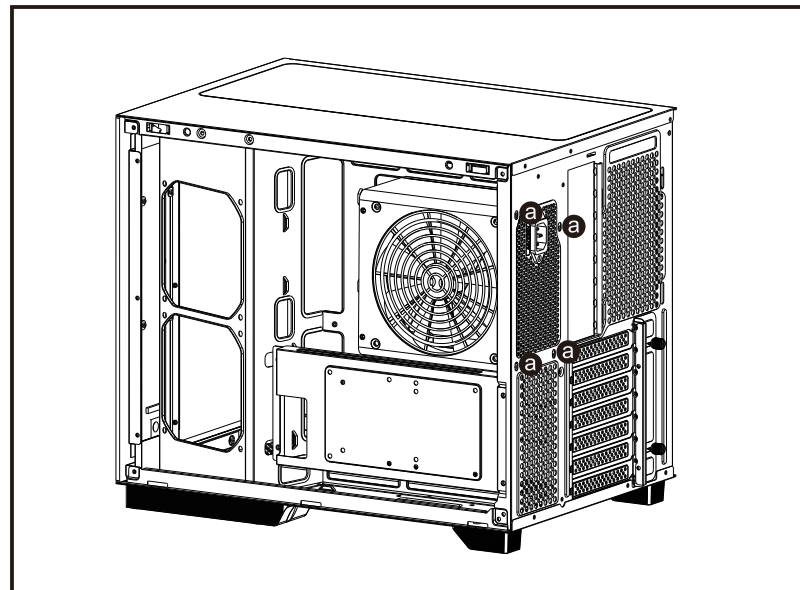

3 M/B installation (support M/B back plug)

Put M/B in the case and align the screw holes, then fix M/B by screws as shown in the following illustration (this case support ATX /micro ATX and ITX M/B).

(different M/B has different installation characteristics, please refer to the user manual of your M/B before installation.)

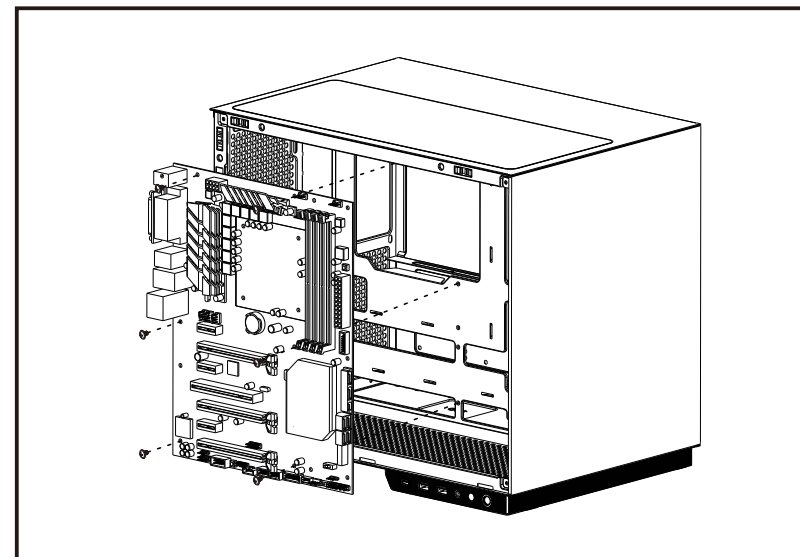

4 VGA card installation

① VGA card standard(horizontal) installation

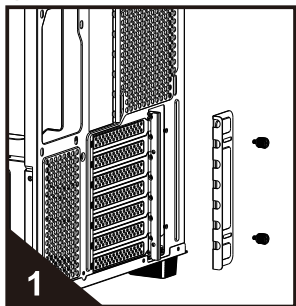

1 Unscrew the screws of the fastening bar of the PCI slot covers, remove the fastening bar

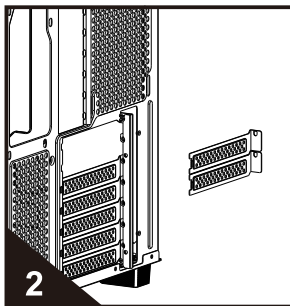

2 Then break off PCI slot cover(s) of the corresponding positions.

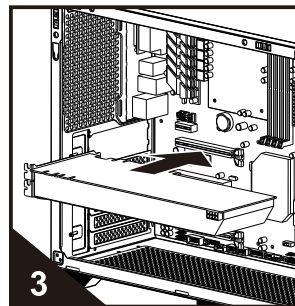

3 Insert VGA card into the slot of M/B according to the arrow direction; Fix VGA card by screws.

② VGA card vertical installation (optional)

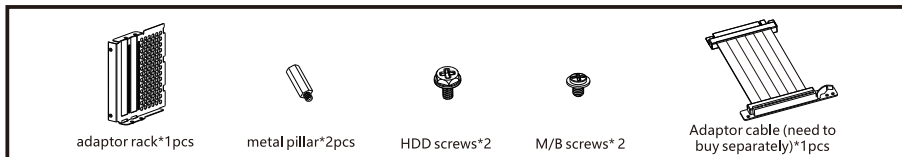

VGA card vertical installation kit is optional, need to buy separately

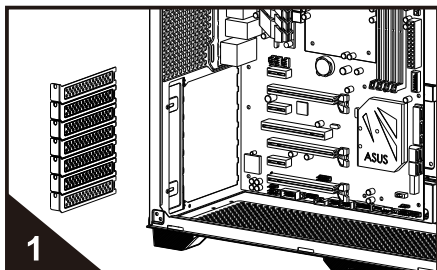

1 Remove the fastening bar of PCI slot covers and all the PCI slot covers

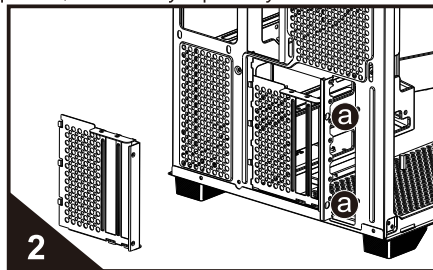

2 Install the adaptor rack in the position of the lower 6 PCI slots as shown in the illustration, secure the adaptor rack at "a" positions by screws

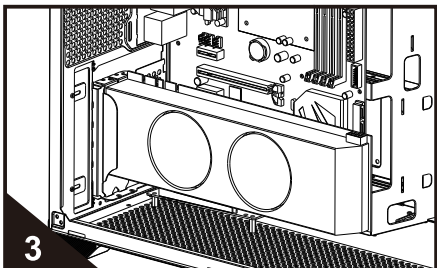

① Fix 2pcs metal pillar on the bottom panel
② Fix the PCB of adaptor cable on metal pillars, insert its another connector in the VGA card slot of M/B
③ Insert VGA card in the slot of the connector of the adaptor cable

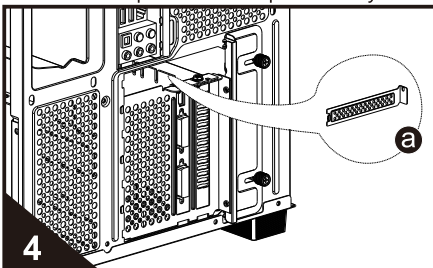

4 Re-cover the PCI slot which is above the installed VGA card by a PCI slot cover (figure a) and secure it by screw

5 HDD/SSD installation (support HDD*1+SSD*2 or HDD*1+SSD*3)

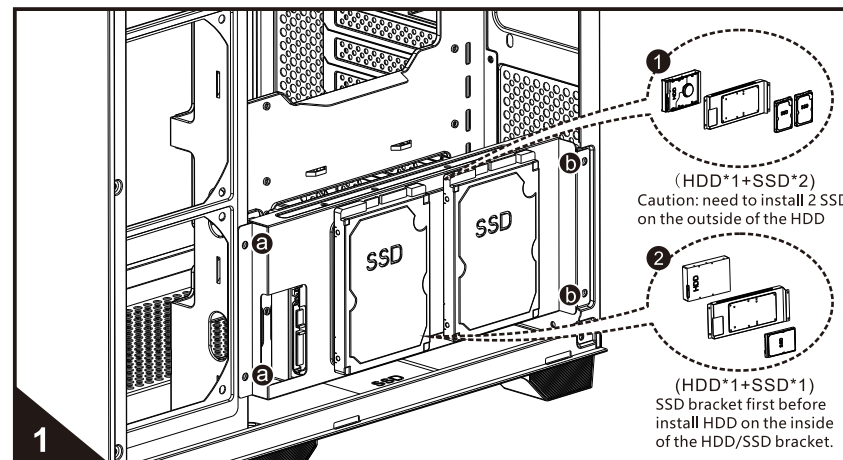

① Unscrew the screws of "a" positions and "b" positions of the HDD/SSD bracket, knock down the bracket.
② Install 1*3.5"HDD + 2*2.5"SSD (figure 1) or 1*3.5"HDD + 1*2.5"SSD (figure 2) on the HDD/SSD bracket.
③ Re-install the HDD/SSD bracket to its original position, and secure it by screws at "a" positions and "b" positions.

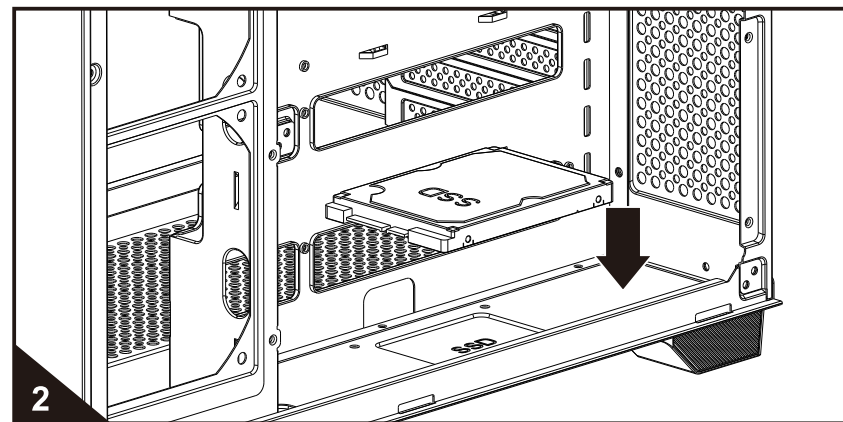

Put 2.5"SSD*1 on bottom panel, secure it by screws from the bottom.

6 Cooling device compatible

Top panel: 3x12cm fan or 1x360 water cooling kit

M/B bracket: 2x12cm fan or 1x240 water cooling kit.

Bottom panel: 3*12cm (if installed VGA card vertically then can not fix fan on bottom panel)

Rear panel: 1x12cm fan